

# STANLEY

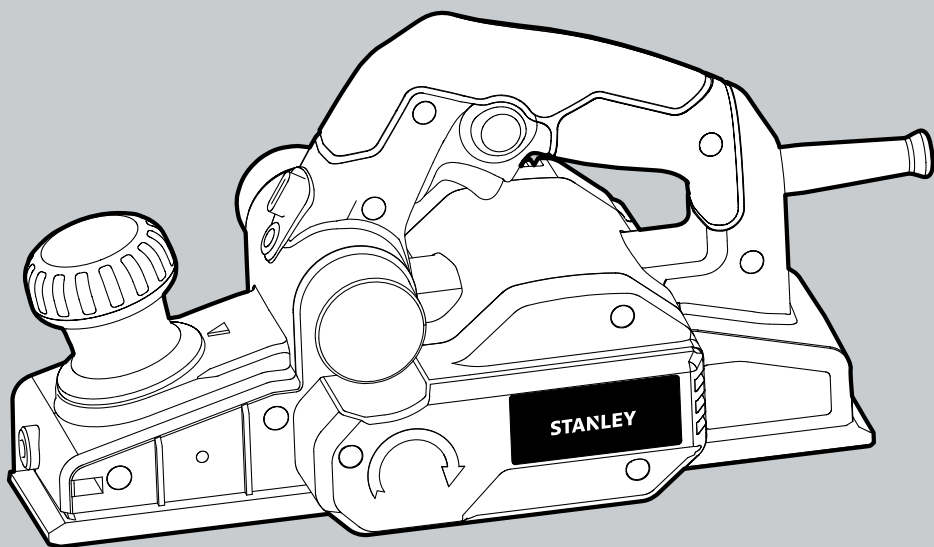

STPP750

English  
简体中文

3  
11

1

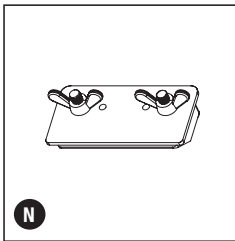
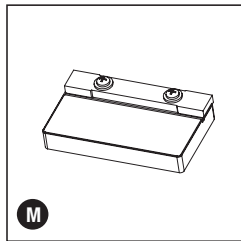
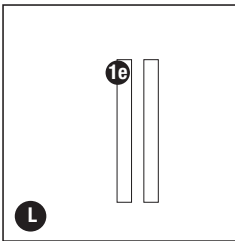
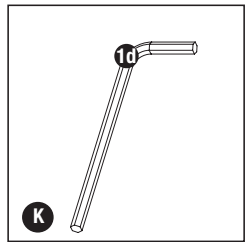
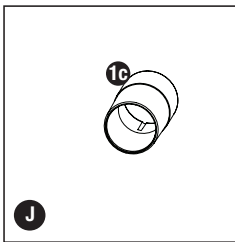
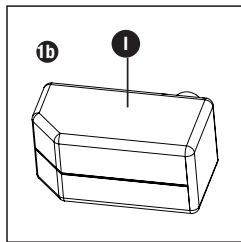
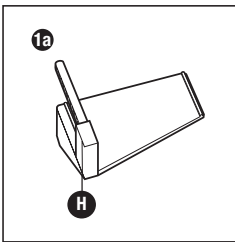
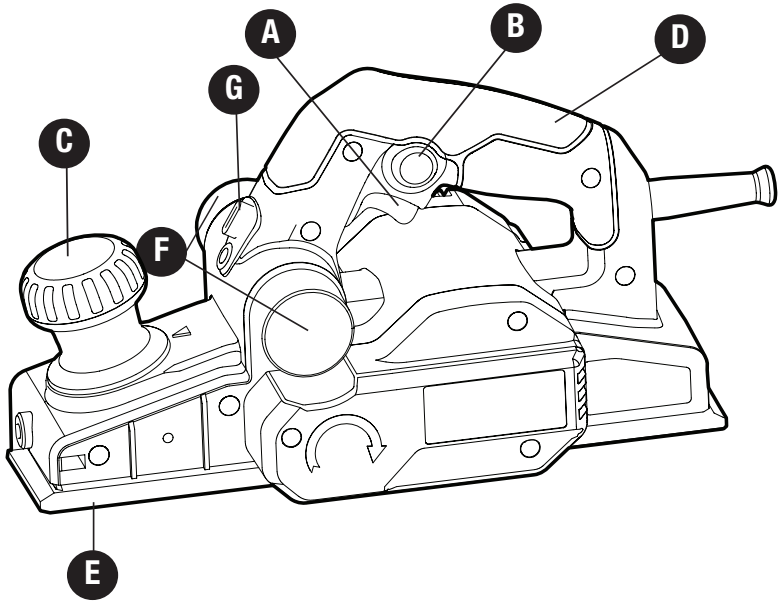

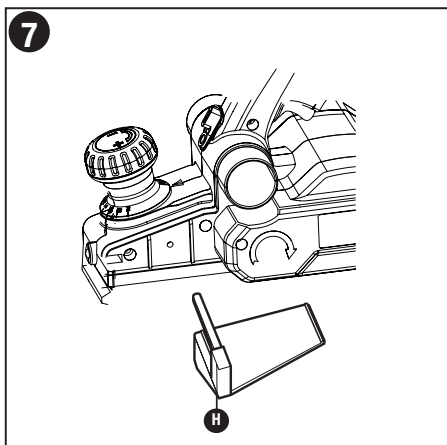
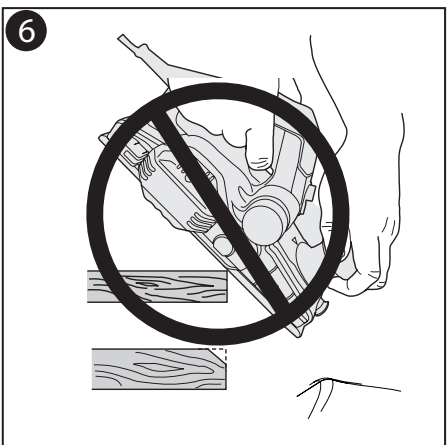
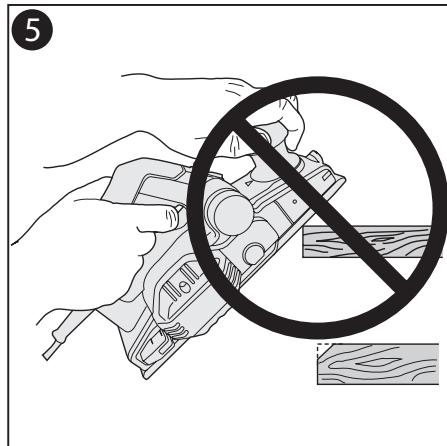
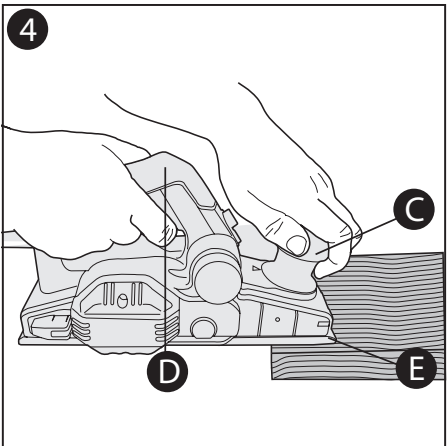
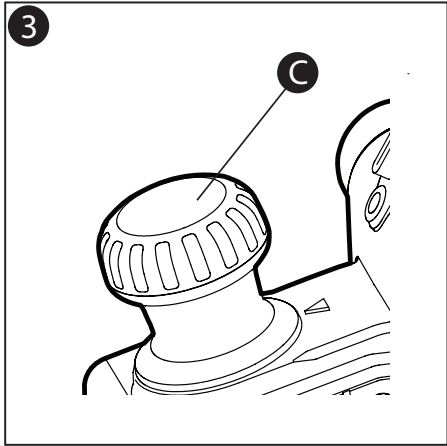
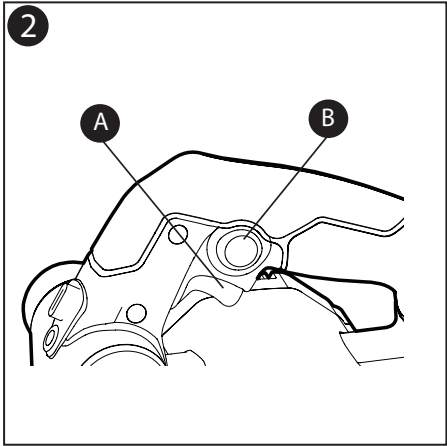

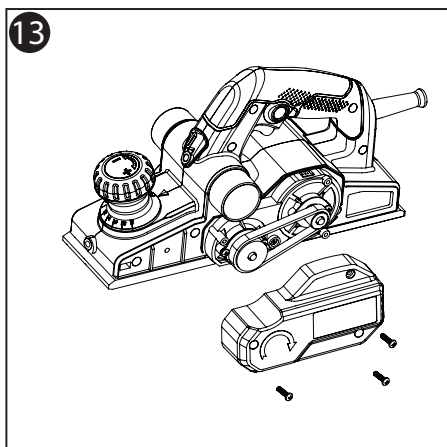
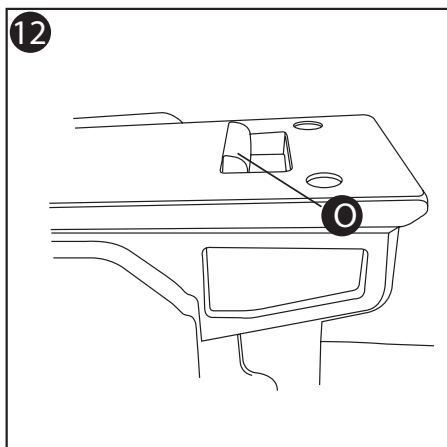
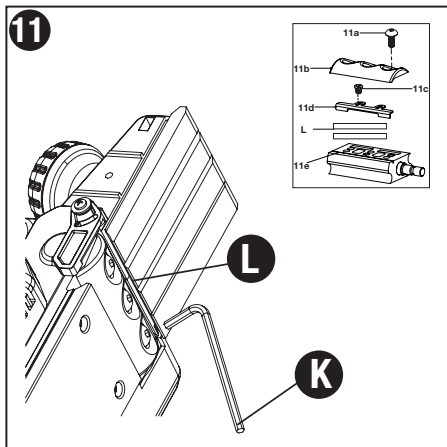
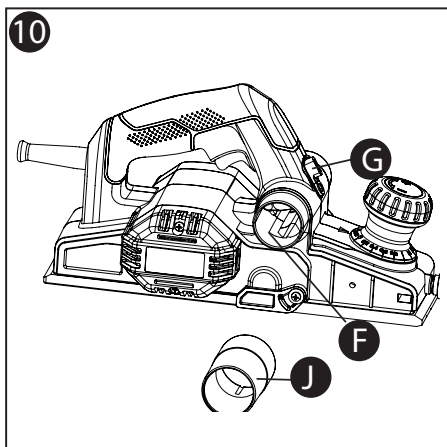
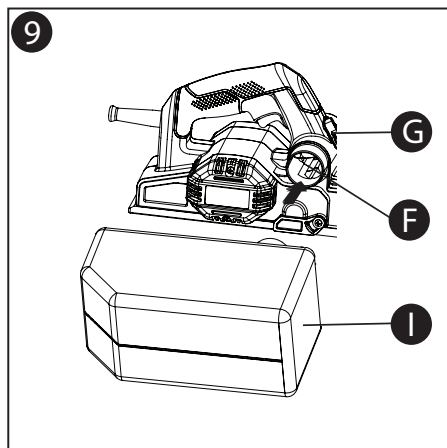
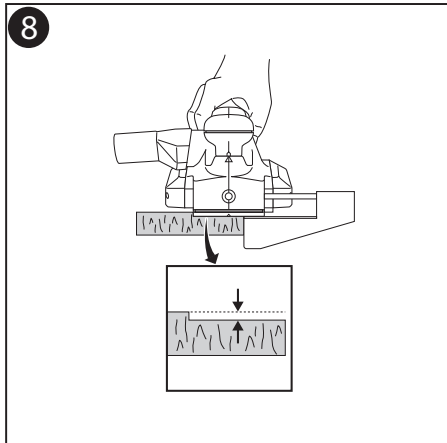

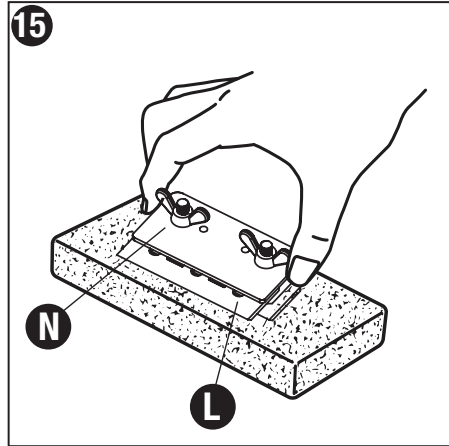
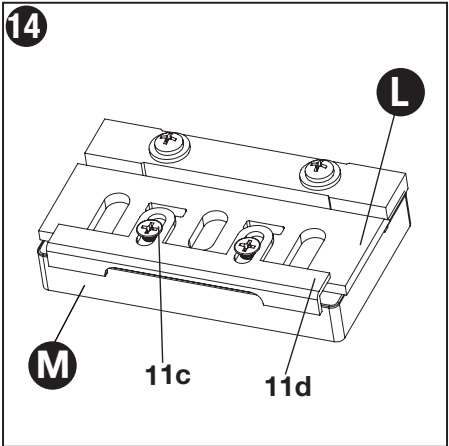

# STPP750 Electric Planer

## Technical Data

Specification	STPP750	
Power input	W	750
No-load speed	/min	16,500
Planing width	mm	82
Planing depth	mm	1.6
Rebating depth	mm	12
Weight	kg	2.7

## Intended use

Your Stanley planer has been designed for planing wood, wood products and plastics. The tool is intended for hand-held use.

## Safety instructions

### General power tool safety warnings



**Warning! Read all safety warnings and all instructions.** Failure to follow the warnings and instructions listed below may result in electric shock, fire and/or serious injury.

### Save all warnings and instructions for future reference.

The term "power tool" in all of the warnings listed below refers to your mains operated (corded) power tool or battery operated (cordless) power tool.

1. **Work area safety**
    - a. **Keep work area clean and well lit.** Cluttered or dark areas invite accidents.
    - b. **Do not operate power tools in explosive atmospheres, such as in the presence of flammable liquids, gases or dust.** Power tools create sparks which may ignite the dust or fumes.
    - c. **Keep children and bystanders away while operating a power tool.** Distractions can cause you to lose control.
  2. **Electrical safety**
    - a. **Power tool plugs must match the outlet. Never modify the plug in any way. Do not use any adapter plugs with earthed (grounded) power tools.** Unmodified plugs and matching outlets will reduce risk of electric shock.
    - b. **Avoid body contact with earthed or grounded surfaces such as pipes, radiators, ranges and refrigerators.** There is an increased risk of electric shock if your body is earthed or grounded.
  - c. **Do not expose power tools to rain or wet conditions.** Water entering a power tool will increase the risk of electric shock.
  - d. **Do not abuse the cord. Never use the cord for carrying, pulling or unplugging the power tool. Keep cord away from heat, oil, sharp edges or moving parts.** Damaged or entangled cords increase the risk of electric shock.
  - e. **When operating a power tool outdoors, use an extension cord suitable for outdoor use.** Use of a cord suitable for outdoor use reduces the risk of electric shock.
  - f. **If operating a power tool in a damp location is unavoidable, use a residual current device (RCD) protected supply.** Use of an RCD reduces the risk of electric shock.
3. **Personal safety**
    - a. **Stay alert, watch what you are doing and use common sense when operating a power tool. Do not use a power tool while you are tired or under the influence of drugs, alcohol or medication.** A moment of inattention while operating power tools may result in serious personal injury.
    - b. **Use personal protective equipment. Always wear eye protection.** Protective equipment such as dust mask, non-skid safety shoes, hard hat, or hearing protection used for appropriate conditions will reduce personal injuries.
    - c. **Prevent unintentional starting. Ensure the switch is in the off-position before connecting to power source and/or battery pack, picking up or carrying the tool.** Carrying power tools with your finger on the switch or energising power tools that have the switch on invites accidents.
    - d. **Remove any adjusting key or wrench before turning the power tool on.** A wrench or a key left attached to a rotating part of the power tool may result in personal injury.
    - e. **Do not overreach. Keep proper footing and balance at all times.** This enables better control of the power tool in unexpected situations.
    - f. **Dress properly. Do not wear loose clothing or jewellery. Keep your hair, clothing and gloves away from moving parts.** Loose clothes, jewellery or long hair can be caught in moving parts.
    - g. **If devices are provided for the connection of dust extraction and collection facilities, ensure these are connected and properly used.** Use of dust collection can reduce dust-related hazards.
  4. **Power tool use and care**
    - a. **Do not force the power tool. Use the correct power tool for your application.** The correct power tool will do the job better and safer at the rate for which it was designed.

- b. **Do not use the power tool if the switch does not turn it on and off.** Any power tool that cannot be controlled with the switch is dangerous and must be repaired.
- c. **Disconnect the plug from the power source and/or the battery pack from the power tool before making any adjustments, changing accessories, or storing power tools.** Such preventive safety measures reduce the risk of starting the power tool accidentally.
- d. **Store idle power tools out of the reach of children and do not allow persons unfamiliar with the power tool or these instructions to operate the power tool.** Power tools are dangerous in the hands of untrained users.
- e. **Maintain power tools. Check for misalignment or binding of moving parts, breakage of parts and any other condition that may affect the power tools operation. If damaged, have the power tool repaired before use.** Many accidents are caused by poorly maintained power tools.
- f. **Keep cutting tools sharp and clean.** Properly maintained cutting tools with sharp cutting edges are less likely to bind and are easier to control.
- g. **Use the power tool, accessories and tool bits etc., in accordance with these instructions, taking into account the working conditions and the work to be performed.** Use of the power tool for operations different from those intended could result in a hazardous situation.

## 5. Service

- a. **Have your power tool serviced by a qualified repair person using only identical replacement parts.** This will ensure that the safety of the power tool is maintained.

## Additional power tool safety warnings



**Warning!** Additional safety warnings for planers

- ◆ **Hold the tool by the insulated gripping surfaces when performing an operation where the cutting tool may contact hidden wiring or its own cord.** Cutting accessory contacting a "live" wire may make exposed metal parts of the power tool "live" and shock the operator.
- ◆ **Use clamps or another practical way to secure and support the workpiece to a stable platform.** Holding the work by hand or against your body leaves it unstable and may lead to loss of control.
- ◆ **Wait for the cutter to stop before setting the tool down.** An exposed cutter may engage the surface leading to possible loss of control and serious injury.
- ◆ **Keep the cutter sharp.** Dull or damaged cutters may cause the planer to swerve or stall under pressure. Always use the appropriate type of cutter for the power tool.

- ◆ Do not touch the workpiece or the cutter immediately after operating the tool. They can become very hot.
- ◆ Remove all nails and metal objects from the workpiece before planing.
- ◆ Always hold the tool with both hands and by the handles provided.
- ◆ Immediately disconnect the cable from the mains if it is damaged or cut.

**Warning!** Contact with, or inhalation of dusts arising from planing applications may endanger the health of the operator and possible bystanders. Wear a dust mask specifically designed for protection against dust and fumes and ensure that persons within or entering the work area are also protected.

- ◆ This tool is not intended for use by persons (including children) with reduced physical, sensory or mental capabilities, or lack of experience and knowledge, unless they have been given supervision or instruction concerning use of the appliance by a person responsible for their safety. Children should be supervised to ensure that they do not play with the appliance.
- ◆ The intended use is described in this instruction manual. The use of any accessory or attachment or performance of any operation with this tool other than those recommended in this instruction manual may present a risk of personal injury and/or damage to property.

## Safety of others

- ◆ This appliance is not intended for use by persons (including children) with reduced physical, sensory or mental capabilities, or lack of experience and knowledge, unless they have been given supervision or instruction concerning use of the appliance by a person responsible for their safety.
- ◆ Children should be supervised to ensure that they do not play with the appliance.

## Electrical safety



This tool is double insulated; therefore no earth wire is required. Always check that the power supply corresponds to the voltage on the rating plate.

- ◆ If the supply cord is damaged, it must be replaced by the manufacturer or an authorised Stanley Service Centre in order to avoid a hazard.

## Features

- A. Trigger switch
- B. Lock-on button
- C. Depth adjustment knob/front handle
- D. Switch Handle
- E. Shoe
- F. Chip discharge chute
- G. Chip deflector lever
- H. Parallel fence
- I. Collection bag(Not included)
- J. Vac adaptor (Not included)
- K. Wrench
- L. Blades
- M. Adjust plate
- N. Sharpening holder

## Operation

### Switch (Figure 2)

**⚠CAUTION:** Check that the tool is not locked ON before connecting it to a power supply. If the trigger switch is locked ON when the tool is connected to the power supply, it will start immediately. Damage to your tool or personal injury may result.

**⚠CAUTION:** Allow the tool to reach full speed before touching tool to the work surface. Lift the tool from the work surface before turning the tool off. To start the planer, depress the trigger switch (A) in **figure 2** . To turn the planer off, release the trigger switch.

### Lock-On Button (Figure 2)

The tool can be locked on for continuous use. To lock the tool ON depress the trigger switch (A) and push in the lock-on button (B). Hold the lock-on button in as you gently release the trigger switch. The tool will continue to run. To turn the tool OFF from a locked-on position, squeeze and release the trigger once.

### Adjusting Planing Depth (Figure 3)

**⚠WARNING:** Turn off and unplug the tool before making any adjustments or removing or installing accessories. Planing depth is infinitely variable from 0 to 1.6 mm. To adjust the cutting depth, rotate the depth adjustment knob/front handle (C) clockwise from the "P" position. The cutting depth will increase from 0 to as much as 1.6mm. It is recommended that test cuts be made in scrap wood after each re-adjustment to make sure that the desired amount of wood is being removed by the planer. Several shallow passes (rather than one deep one) will produce a smoother finish.

### Planing (Figures 4, 5, 6)

**⚠CAUTION:** Allow the tool to reach full speed before touching tool to the work surface. Lift the tool from the work surface. Lift the tool from the work surface before turning the tool off.

Hold the planer in the correct position with one hand on the front handle (C) and the other hand on the switch handle (D) as shown in **figure 4** . Place the front of the shoe (E) on the surface to be planed, making certain that the cutting blades are not touching the surface. Push down firmly on the front handle of the planer so that the front shoe is ABSOLUTELY FLAT on the work surface. Squeeze the trigger switch and allow the motor to reach full speed before touching the planer blades to the work surface. Move the tool slowly into the work and maintain downward pressure to keep the planer flat. Be particularly careful to keep the tool flat at the beginning and the end of the work surface (**Figures 4, 5, 6** ).

**Planing Tip:** For a smoother appearance, fasten a piece of scrap wood to the end of the piece you are planing. Don't stop planing until the cutting blades of the planer are past your work piece and into the scrap material.

### Parallel Fence (Figures 7, 8)

**⚠WARNING:** Turn off and unplug the tool before making any adjustments or removing or installing accessories.

**⚠CAUTION:** Allow the tool to reach full speed before touching tool to the work surface. Lift the tool from the work surface before turning the tool off.

The rabet fence can be installed on either side of your planer. The planer can make rabet cuts up to 12mm.

### Fitting and removing the parallel fence(fig.7)

The parallel fence is used to for optimum control on narrow workpieces.

- ◆ loosen the locking knob(9).
- ◆ insert the parallel fence(H)through the opening(10).
- ◆ slide the parallel fence into the desired position.

### Rebating(fig.8)

- ◆ Fit and adjust the parallel fence.
- ◆ proceed as for planing.

### Collection Bag (Figure 9)

**⚠ WARNING:** Turn off and unplug the tool before making any adjustments or removing or installing accessories (**Bag not included in all models**).

- a. Attach bag (I) to either side of chip discharge chute (F). Empty bag often to prevent clogging. b. To prevent chips from coming out opposite side of chip discharge chute, move chip deflector lever (G) to the opposite side of the bag.



**Vacuum Adaptor (Figure 10)**

**⚠ WARNING: Turn off and unplug the tool before making any adjustments or removing or installing accessories.**

- Slide the vac adaptor (J) over the chip discharge chute (F).
- Connect a vacuum cleaner hose (not included) to the adaptor.
- To prevent chips from coming out opposite side of chip discharge chute, move chip deflector lever (G) to the opposite side of the adaptor.

**To Change Blades (Figure 11)**

**⚠ WARNING: Turn off and unplug the tool before making any adjustments or removing or installing accessories.**

**⚠ WARNING: Cut Hazard. Planer blades are sharp and must be handled with care.**

**NOTE:** The STEL630 has two blades, one on each side of the blade drum. Any operation or adjustment should be made to both blades.

**To Remove Blade (Figure 11)**

- Remove the three bolts (11a) with the wrench (K) supplied.
- Remove drum cover (11b) and remove the blade (L) out of its holder.
- Place the blade or replaced it.

**To Reinstall Blade**

- Replace the drum cover (11b). Make sure that the blade is flush with the planing shoe.
- Tighten the three bolts (11a) .

**⚠** Always replace both blade.

**Parking Foot (Figure 12)**

Your planer is equipped with a parking foot (O) that automatically lowers into place when the tool is lifted from the work surface. When planing, the parking foot raises as the tool is pushed forward. When the parking foot is lowered, the planer can set on the work surface without the blade touching.

**⚠ CAUTION:** Do not lock the trigger switch on and engage the parking foot. The vibration of the running motor will cause the planer to move, possibly falling from the work piece.

**Drive Belt (Figure 13)**

**WARNING:** Turn off and unplug the tool before making any adjustments or removing or installing accessories.

**To Replace Belt**

- Loosen the three screws shown in **Figure 13** and remove the belt cover.
- Remove old belt.
- Place new belt over front pulley then rotate belt clockwise while pushing belt onto back pulley.

- Attach belt cover and securely tighten screws.

**Adjusting cutters (Figure 14)**

- Place the blade (L) on the adjust plate (M), and make the blade edge perfectly flush with the inside edge of the adjust plate (M).
- Place the bracket (11d) on the blade and make the flange of bracket flush with the back side of the adjust plate.
- Tighten the two screws (11c) on the bracket.
- Slip the flange of the bracket into the groove of drum (11e), place the drum cover (11b) and tighten the three bolts (11a).

**Sharpening blades (Figure 15)**

- Fasten the blades to sharpening holder (N). Be sure both blades edges face in the same direction.
- Place the blades edges so that they rest flat on the grinding stone.
- Firmly grip the sharpening holder and move back and forward to sharpen the blades (L).

**Residual risks**

Additional residual risks may arise when using the tool which may not be included in the enclosed safety warnings. These risks can arise from misuse, prolonged use etc.

Even with the application of the relevant safety regulations and the implementation of safety devices, certain residual risks can not be avoided. These include:

- ◆ **Injuries caused by touching any rotating/moving parts.**
- ◆ **Injuries caused when changing any parts, blades or accessories.**
- ◆ **Injuries caused by prolonged use of a tool. When using any tool for prolonged periods ensure you take regular breaks.**
- ◆ **Impairment of hearing.**
- ◆ **Health hazards caused by breathing dust developed when using your tool (example:- working with wood, especially oak, beech and MDF.)**

**Use**

**Warning!** Let the tool work at its own pace. Do not overload.

- ◆ Adjust the depth of cut.
- ◆ If necessary, fit and adjust the parallel fence.

**Hints for optimum use**

- ◆ Move the tool along the grain of the wood.
- ◆ If the grain is cross or curly, or if the workpiece material is a hard type of wood, adjust the depth of cut to take only a very thin shaving at each pass and take several passes to achieve the desired result.
- ◆ To keep the tool in a straight line, press down the front of

the tool at the start, and press down the back of the tool at the end of the cutting stroke.

## Accessories

The performance of your tool depends on the accessory used. Stanley accessories are engineered to high quality standards and designed to enhance the performance of your tool. By using these accessories you will get the verybest from your tool.

## Maintenance

Your tool has been designed to operate over a long period of time with a minimum of maintenance. Continuous satisfactory operation depends upon proper tool care and regular cleaning.

**Warning!** Before performing any maintenance, switch off and unplug the tool.

- ◆ Regularly clean the ventilation slots in your tool using a soft brush or dry cloth.
- ◆ Regularly clean the motor housing using a damp cloth. Do not use any abrasive or solvent-based cleaner.

## Replacing the drive belt (fig. 13)

- ◆ Loosen the screws and remove the cover .
- ◆ Remove the old drive belt.
- ◆ Place the new belt over the pulleys. Place the belt over the large pulley first, then over the small pulley, whilst manually rotating the belt steadily.
- ◆ Put the cover back in place and tighten the screws.

## Protecting the environment



Separate collection. This product must not be disposed of with normal household waste.

Should you find one day that your Stanley product needs replacement, or if it is of no further use to you, do not dispose of it with household waste. Make this product available for separate collection.



Separate collection of used products and packaging allows materials to be recycled and used again. Re-use of recycled materials helps prevent environmental pollution and reduces the demand for raw materials.

Local regulations may provide for separate collection of electrical products from the household, at municipal waste sites or by the retailer when you purchase a new product.

## STPP750 750W电刨

### 技术参数

		STPP750
功率	W	750
空载转速	/min	16,500
刨削宽度	mm	82
刨削深度	mm	1.6
槽口深度	mm	12
重量	kg	2.7

### 设计用途

您的 Stanley 电刨机设计用于刨光木材、木制品和塑料。本工具使用方法手提式。

### 电动工具通用安全警告



**警告！** 阅读所有警告和所有说明。不遵照以下警告和说明会导致电击、着火和 / 或严重伤害。

#### 保存所有警告和说明书以备查阅。

在所有下列的警告中术语“电动工具”指市电驱动（有线）电动工具或电池驱动（无线）电动工具。

#### a) 工作场地的安全

- 1) 保持工作场地清洁和明亮。混乱和黑暗的场地会引发事故。
- 2) 不要在易爆环境，如有易燃液体、气体或粉尘的环境下操作电动工具。电动工具产生的火花会点燃粉尘或气体。
- 3) 让儿童和旁观者离开后操作电动工具。注意力不集中会让你失去对工具的控制。

#### b) 电气安全

- 1) 电动工具插头必须与插座相配。绝不能以任何方式改装插头。需接地的电动工具不能使用任何转换插头。未经改装的插头和相配的插座将减少电击危险。
- 2) 避免人体接触接地表面，如管道、散热片和冰箱。如果你身体接地会增加电击危险。
- 3) 不得将电动工具暴露在雨中或潮湿环境中。水进入电动工具将增加电击危险。

- 4) 不得滥用电线。绝不用电线搬运、拉动电动工具或拔出其插头。使电线远离热源、油、锐边或运动部件。受损或缠绕的软线会增加电击危险。
- 5) 当在户外使用电动工具时，使用适合户外使用的外接软线。适合户外使用的软线将减少电击危险。
- 6) 如果在潮湿环境下操作电动工具是不可避免的，应使用剩余电流动作保护器（RCD）。使用RCD可减少电击危险。

#### c) 人身安全

- 1) 保持警觉，当操作电动工具时关注所从事的操作并保持清醒。当你感到疲倦，或在有药物、酒精或治疗反应时，不要操作电动工具。在操作电动工具时瞬间的疏忽会导致严重人身伤害。
- 2) 使用个人防护装置。始终佩戴护目镜。安全装置，诸如适当条件下使用防尘面具、防滑安全鞋、安全帽、听力防护等装置能减少人身伤害。
- 3) 防止意外起动。确保开关在连接电源和/或电池盒、拿起或搬运工具时处于关断位置。手指放在已接通电源的开关上或开关处于接通时插入插头可能会导致危险。
- 4) 在电动工具接通之前，拿掉所有调节钥匙或扳手。遗留在电动工具旋转零件上的扳手或钥匙会导致人身伤害。
- 5) 手不要伸展得太长。时刻注意立足点和身体平衡。这样在意外情况下能很好地控制电动工具。
- 6) 着装适当。不要穿宽松衣服或佩戴饰品。让你的衣服、手套和头发远离运动部件。宽松衣服、配饰或长发可能会卷入运动部件中。
- 7) 如果提供了与排屑、集尘设备连接用的装置，要确保他们连接完好且使用得当。使用这些装置可减少尘屑引起的危险。

#### d) 电动工具使用和注意事项

- 1) 不要滥用电动工具，根据用途使用适当的电动工具。选用适当设计的电动工具会使你工作更有效、更安全。
- 2) 如果开关不能接通或关断工具电源，则不能使用该电动工具。不能用开关来控制的电动工具是危险的且必须进行修理。

- 3) 在进行任何调节、更换附件或贮存电动工具之前，必须从电源上拔掉插头和 / 或使电池盒与工具脱开。这种防护性措施将减少工具意外起动的危险。
- 4) 将闲置不用的电动工具贮存在儿童所及范围之外，并且不要让不熟悉电动工具或对这些说明不了解的人操作电动工具。电动工具在未经培训的用户手中是危险的。
- 5) 保养电动工具。检查运动件是否调整到位或卡住，检查零件破损情况和影响电动工具运行的其他状况。如有损坏，电动工具应在使用前修理好。许多事故由维护不良的电动工具引发。
- 6) 保持切削刀具锋利和清洁。保养良好的有锋利切削刃的刀具不易卡住而且容易控制。
- 7) 按照使用说明书，考虑作业条件和进行的作业来使用电动工具、附件和工具的刀头等。将电动工具用于那些与其用途不符的操作可能会导致危险。

#### e) 维修

- 1) 将你的电动工具送交专业维修人员，使用同样的备件进行修理。这样将确保所维修的电动工具的安全性。

## 电动工具附加安全警示



**警告！** 请遵守所有安全附则

- ◆ 在切割配件可能接触隐藏的导线或电动工具自身导线的情况下，请仅握持绝缘的把手表面。如果切割配件接触“带电”导线，工具暴露金属部件的表面会“带电”，并且导致操作员触电。
- ◆ 请使用夹钳或其他切实可行的方法来固定和支撑工件，将其固定到稳定的工作台上。用手抓住工件或用身体抵住工件并不稳定，可能会导致工件失控。
- ◆ 等刨刀停止运动后再放置工具。外露的刨刀可能会切入表面而引发可能的失控和严重的伤害事故。
- ◆ 刚刚使用后，工件或刃具会变得很烫，应避免立即接触。

- ◆ 开工前，应清除工件中所有钉子和金属物体。
- ◆ 始终双手握持工具的手柄。
- ◆ 如果电源线被损坏或刨切，应立即与主电网断开。

**警告！** 如果接触或吸入刨工作业时产生的粉尘，会危害操作者及在场人员的健康。请佩戴防尘、防烟专用面罩，并确保进入或处于工作场所的人员也得到保护。

- ◆ 除非其安全负责人进行工具使用的监督或指导，否则体力、感知能力或心智不足的人（包括儿童）、以及缺乏相关经验与知识的人不得使用本工具。必须看管儿童，勿使其拿本工具玩耍。
- ◆ 本使用手册中说明了工具的设计用途。如果使用手册建议之外的配件、附件或进行手册建议之外的工具操作，会引起人身伤害或财产损坏的风险。

## 工具上的标志

本工具有如下图形标志：



**警告！** 为降低伤害风险，使用前务必阅读使用手册。

## 电气安全



本工具采用双重绝缘；因此不需要地线。请务必检查电源是否与铭牌上的电压一致。

如果电源线损坏，务必由厂商或百得授权服务中心更换，以排除隐患。

### 特性

本工具有以下多项或全部特性：

- A. 触发开关
- B. 锁定按钮
- C. 深度调节旋钮/前手柄
- D. 开关手柄
- E. 底板
- F. 排屑槽
- G. 刨屑偏导杆
- H. 平行导板
- I. 集尘袋（不提供）

- K.扳手
- L.刨刀
- M.调节板
- N.磨刀架

## 操作

### 开关 (图2)

**△ 注意！**连接电源之前，请检查并确保工具没有锁定在启动位置。如果连接电源时工具的触发开关锁定在启动位置，工具将立即启动，因而导致工具损坏和人身伤害。

**△ 注意！**工具在接触工件表面之前，必须达到全速；工具离开工件表面之后，再关闭工具。要启动电刨，按图2所示，按下触发开关 (A) 即可。要关闭工具，请释放触发开关。

### 锁定按钮 (图2)

工具可以锁定后连续使用。要锁定工具，按下触发开关 (A) 并按下锁定按钮 (B)。按住锁定按钮的同时，轻轻释放触发开关，工具会持续运转。要在锁定位置关闭工具，请挤压并释放触发开关一次。

### 刨深的调整 (图3)

**△ 警告：**调整、拆卸或安装配件之前，请关闭工具并拔下电源插头。刨深可在0至1.6毫米间无极调整。要调整刨深，从“P”位置顺时针转动深度调节旋钮/前手柄 (C)。刨切深度将从0开始增加，直至1.6毫米。建议每次调整后，在废木料上试刨几次，确保刨削量符合要求。多趟浅刨（而非一趟深刨）后的表面会更为光滑。

### 刨削 (图4、5、6)

**△ 注意！**工具在接触工件表面之前，必须达到全速；工具离开工件表面之后，在关闭工具。一双手握住前手柄 (C) 的正确位置，另一双手握住开关手柄 (D)，如图4所示。把底板 (E) 前部置于待刨表面上，确保刨刃未接触表面。用力按下前手柄，使前底板与工件表面绝对平贴；挤压触发开关，待马达达到全速后，让刨刃接触工件表面。向工件缓慢移动工具，保持向下压力，使电刨平贴工件。尤其

是在工件表面的开始和结束部分，应确保工具平贴 (图4、5、6)。

刨削提示：要获得更为光滑的表面，可在工件末端固定一块废木料。在刨刀通过工件并刨削废木料前，不要停止。

### 平行导板 (图7、8)

**△ 警告：**调整、拆卸或安装配件之前，请关闭工具并拔下电源插头。

**△ 注意！**工具在接触工件表面之前，必须达到全速，工具离开工件表面之后，在关闭工具。

槽口导板可安装在电刨的任一侧。槽口最大深度12毫米。

### 平行导板的安装与拆卸 (图7)

平行导板可实现窄工件的最佳控制。

- ◆ 松开锁定按钮 (9)。
- ◆ 通过开口 (10) 插入平行导板 (H)。
- ◆ 把平行导板滑动到所需位置。

### 开槽口 (图8)

- ◆ 安装平行导板并进行调整。
- ◆ 按照刨削程序操作。

### 集尘袋 (图9)

**△ 警告：**调整、拆卸或安装配件之前，请关闭工具并拔下电源插头。

- a. 把集尘袋 (I) 连接到排屑槽 (F) 的任一侧。集尘袋应不时清空，防止堵塞。
- b. 为防止刨屑从排屑槽的另一侧喷出，请把刨屑偏导杆 (G) 移向与袋子相对的一侧。

### 真空适配器 (图10)

**△ 警告：**调整、拆卸或安装配件之前，请关闭工具并拔下电源插头

- a. 把真空适配器 (J) 滑动安装到排屑槽 (F) 上。
- b. 把真空适配器软管 (未提供) 连接到适配器上。
- c. 为防止刨屑从排屑槽的另一侧喷出，请把刨屑偏导杆 (G) 移向与适配器相对的一侧。

### 更换刨刀 (图11)

**⚠ 警告：调整、拆卸或安装配件之前，请关闭工具并拔下电源插头。**

**⚠ 警告：切割伤害。刨刃锋利，必须小心处理。**

**说明：**STPP750有两片刨刀，分别位于刨鼓的两侧。操作与调整刨刀时，必须两片同时进行。

### 拆卸刨刀 (图11)

- 使用随机提供的扳手 (K)，取下三个螺钉栓 (11a)。
- 取下刨鼓挡板 (11b)，然后把刨刀 (L) 从刀槽中取出。
- 安装或更换刨刀。

### 重新安装刨刀

- 把刨鼓挡板 (11b) 回位，确保刨刀与刨底板平齐。
- 紧固三个螺栓 (11a)。

**⚠ 两个刨刀务必同时更换。**

### 停机架 (图12)

本电刨设计有停机架 (O)。在工件上提起工具时，停机架会自动下降到位。刨削作业时，前推工具会使停机架升起。停机架下降后，可将工具放在工件表面，而刨刀不会接触工件。

**⚠ 警告：调整、拆卸或安装配件之前，请关闭工具并拔下电源插头。**

### 传动带 (图13)

**警告：调整、拆卸或安装配件之前，请关闭工具并拔下电源插头。**

### 更换皮带

- 松开图13中的三个螺钉，取下皮带罩。
- 取下旧皮带。
- 把新皮带置于前带轮上，把皮带推上后带轮的同时顺时针转动皮带。
- 安装皮带罩，拧紧螺钉。

### 刀具调节 (图14)

- 把刨刀 (L) 置于调节板 (M) 上，使刀刃边缘与调节板 (M) 的内棱完全平齐。
- 把托架 (11b) 置于刨刀上，并使托架边缘与调节板的背侧平齐。
- 紧固托架上的两个螺钉 (11c)。
- 把托架边缘滑动到刨鼓 (11e) 上的凹槽内。

### 磨刨刀 (图15)

- 把刨刀固定到磨刀架 (N) 上。确保两个刨刀刀刃方向一致。
- 放置刨刀时，保持刀刃与磨石平贴。
- 紧握磨刀架并往复移动，打磨刨刀 (L)。

### 残余风险

当工具的使用超出本安全警告范围时，会带来额外的残余风险。这些风险可能来自使用不当、使用时间过长等。

即使落实了相关的安全法规、采用安全装置，某些残余风险是不可避免的，它们是：

- ◆ 接触旋转/活动部件造成的人身伤害。
- ◆ 更换部件、刀具或配件造成的人身伤害。
- ◆ 使用时间过长时导致的伤害。使用任何工具时间过长时，请确保定期休息。
- ◆ 听力损伤。
- ◆ 吸入使用时产生的粉尘多带来的健康隐患（例如：工作对象为木材特别是橡木、山毛榉和中密度纤维板时）。

### 使用

**警告！**让工具在自由节奏下工作，切勿过载。

- ◆ 调整刨削深度。
- ◆ 必要时，安装并调整平行导板。

### 最佳应用提示

- ◆ 沿着木材的纹路移动工具。
  - ◆ 如果木材纹路交叉或褶皱，或木材较硬，应调整刨深，使每趟刨深很浅，通过多趟刨削达到所需效果。
- 要使工具保持直线，开始时按下工具前部，在一趟结束时，按下工具后部。

## 配件

所有电动工具的性能均取决于所用的配件。百得配件依据高质量标准设计，能够强化电动工具的性能。使用百得配件，可以确保您的百得工具可以发挥最出色的性能。

## 维护

您的百得电动工具设计精良，可以长期运作，而只需极少的维护。要取得连续的令人满意的工作效果，需要您做合适的保养和定期的清洁。

**警告！** 在保养任何有绳/无绳电动工具之前，请：

- ◆ 使用软刷或干布定期清洁工具是通风口。
- ◆ 使用湿布定期清洁马达外壳。切勿使用任何研磨型或溶剂型清洁剂。

## 更换传动带（图13）

- ◆ 松开螺钉，取下皮带罩。
- ◆ 取下旧皮带。
- ◆ 把新皮带置于皮带轮上。首先置于大轮上，然后是小轮，同时用手平稳转动皮带。
- ◆ 把皮带罩装好并拧紧螺钉。

## 保护环境



分类回收。本产品不得与普通家庭垃圾一起处理。

如果某一天您发现必须更换您的百得产品，请不要把它和家庭垃圾一起处理，请把该产品单独分类回收。



旧产品和旧包装的分类回收使材料能够得以再循环和再利用。再循环材料的重新利用有助于防止环境污染和减少原材料需求。

在市政垃圾场或您购买新产品的零售商处，地方法规可能要求电器产品与生活垃圾分开回收。

**制造商：史丹利五金工具（上海）有限公司**

**地 址：上海市外高桥保税区泰谷路88号  
丰谷大楼六层676A室**

**产 地：江苏苏州**